



CYLINDRICAL LOCKSET

BSI offers heavy duty cylindrical locksets, ideal for new or retrofit construction. The solenoid control with dual voltage, and field of fail secure, or fail safe.

5100 SERIES GRADE 1 LEVERSET



GRADE 1



Underwriters Laboratories Inc.®



Trim types



Eclipse rose



Galaxy rose

General Feature

1. 5100 Standard - Certificated by ANSI A156.2-2003.
2. UL listed - Mechanical meets UL 3 hours fire rating.
3. Current draw: 600mA@12VDC, 300mA@24VDC
4. Wide variety of compatible locksets for other famous brands like Schlage, Arrow, Best, Falcon & KSP.
5. Standard Specifications:
 - (1) Lever: zinc, 125mm(From Lock center to Lever end)
 - (2) Rose: Φ 90mm.
 - (3) Door thickness: 35mm~51mm(1"-3/8 ~ 2")
 - (4) Backset: 60mm or 70mm
 - (5) Latch status
6. Clutch Function: The exterior lever have releasing to prevent heavy impact while pressing the lever at locking position.
7. Key latch retraction
8. Finish: US26D, US32D

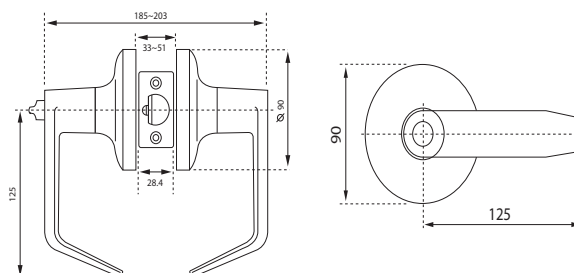

5100 GRADE 1 ELECTRIC LEVERSET



GRADE 1



Underwriters Laboratories Inc.®



5100-S ELECTRIC LOCKSET WITH SOLENOID

STANDARD WIRING
Dual Coil Solenoid

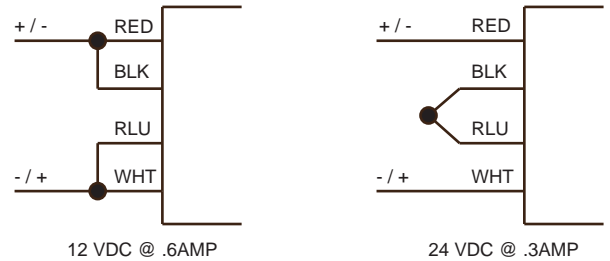

5100-M ELECTRIC LOCKSET WITH MOTOR

MORTOR SPEC. SHEET

No Load		Rated Load		Starting Torque (g-cm)	End Play	Output Shaft	Shaft Direction	Ansi-Static
Speed (r.p.m)	Current (mA)	Speed (r.p.m)	Current (mA)					
16400	<40	12000	<175	>10.5	0.05~0.30	4.0±0.2	CCW	250V 10MΩ